

Hazle  
Luzerne

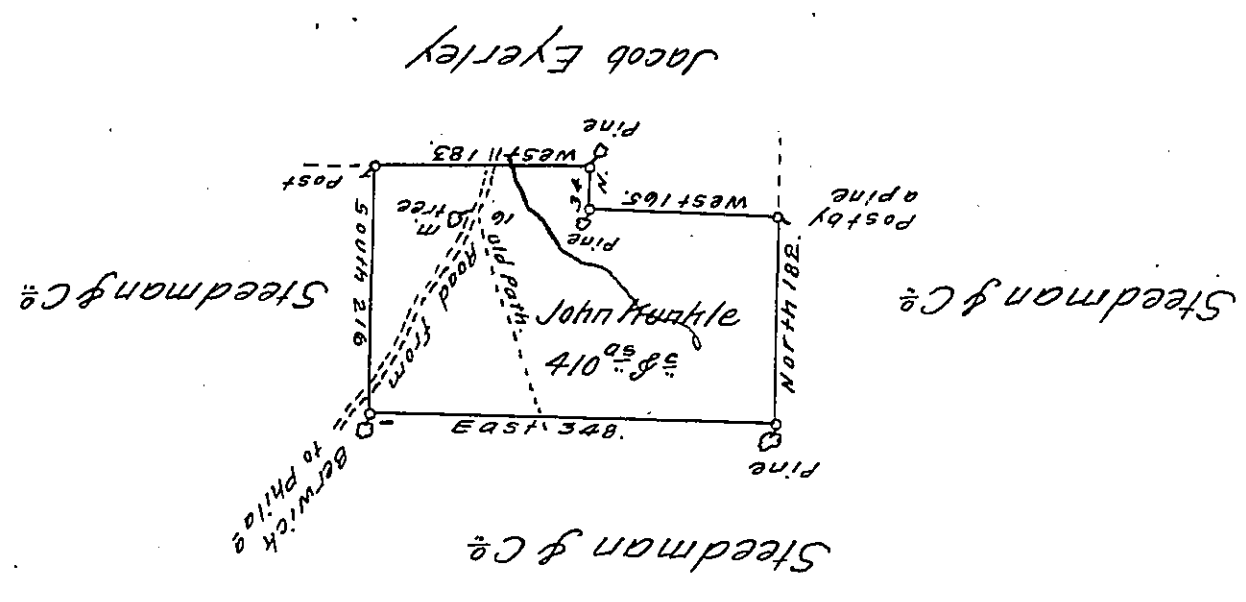

A Draft of a tract of land Called Station Situate in the County of North<sup>d</sup>. Containing four Hundred & ten Acres and Allowe Surv<sup>d</sup> for John Kunkle (obl.)<sup>th</sup> Day of Sep<sup>r</sup> 1793 ~~for John Kunkle~~ by Vir- tue of a Warrant dated the 5<sup>th</sup> day of March 1793.

To Daniel Brodhead Esq<sup>r</sup>. } by W<sup>m</sup> Gray D.S.  
Surv<sup>r</sup> Gen!

IN TESTIMONY that the above is a copy of the original remaining on file in the Department of Internal Affairs of Pennsylvania, made conformably to an Act of Assembly approved the 16th day of February, 1833, I have hereunto set my Hand and caused the Seal of said Department to be affixed at Harrisburg, this fifteenth day of February 1912.

*Nancy Howell*  
Secretary of Internal Affairs.